

# 119 20TH STREET

## UNIT 22

927 SQ. FT. STRATA

8' CEILINGS

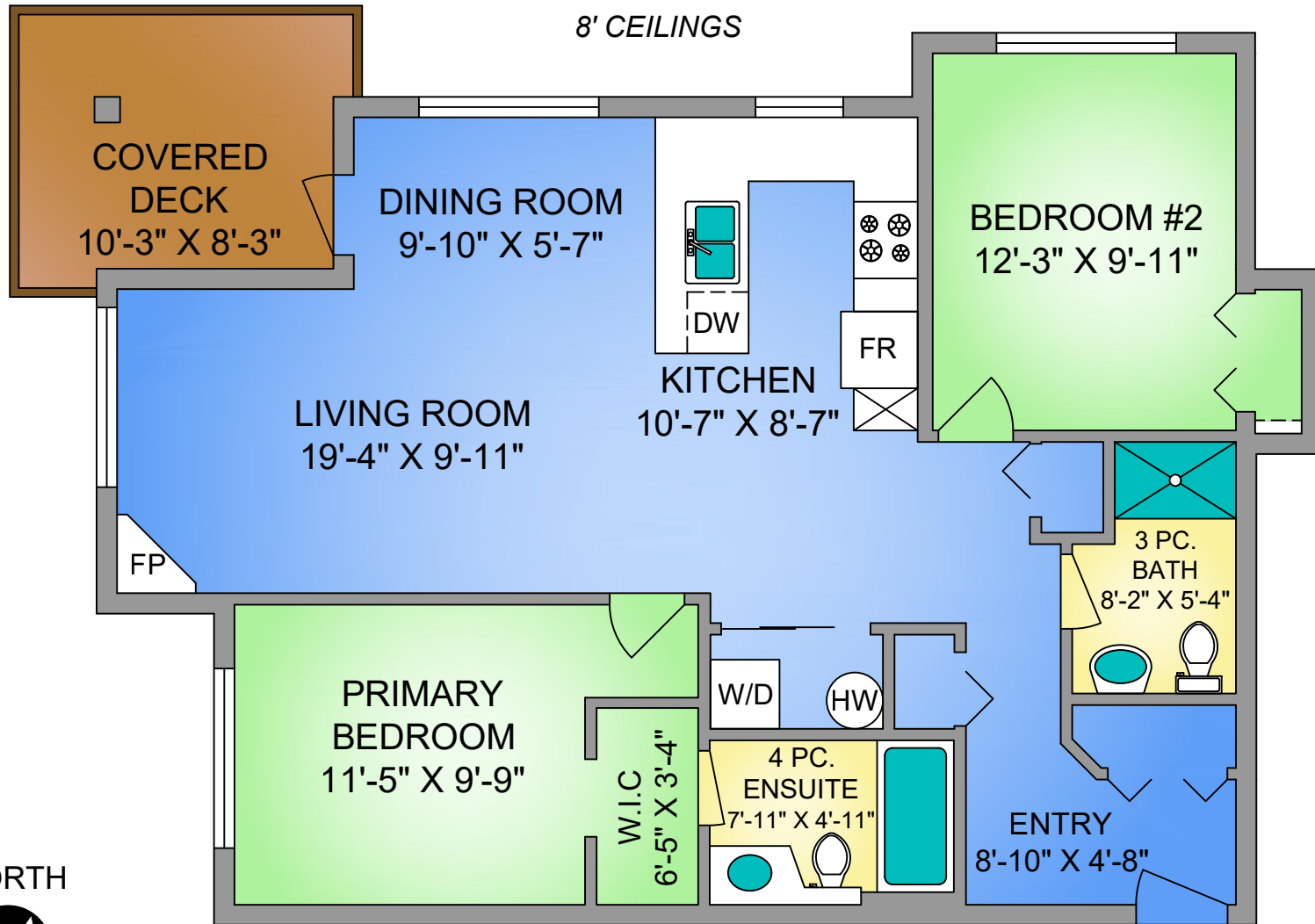

NORTH

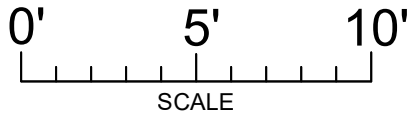

SCALE

22-119 20TH ST.  
NOV. 25, 2022

Prepared by PROPER MEASURE NORTH ISLAND for the exclusive use of COURTNEY & ANGLIN REAL ESTATE GROUP  
Plans may not be 100% accurate. Buyer must verify any critical measurement.

Private resale or modification of floor plans to a third party by any individual or entity other than Proper Measure North Island is strictly prohibited

FLOOR	AREA (SQ. FT.)	
	FINISHED SQ.FT.	DECK
MAIN	927	90
TOTAL	927	90